

PRODUCT INFORMATION MODEL 8200 SOLID.

© 2019 KURT BEIER & KATI QUINGER



Covered cabinet doors
With filigree wooden frame



High-quality Genuine wood,
old oak





Filigree metal frame

SOLID.: CHOOSE YOUR STYLE

CABINETS, BOARDS AND SHELVES WITH A MODERN, SOPHISTICATED LINE, CUSTOMIZABLE. CAN BE PLACED ON THE WALL AS A SOLITAIRE OR AS A ROOM DIVIDER. CREATIVE MATERIAL MIX WITH WOODEN BODY ON FINE STEEL FRAME, BLACK STRUCTURE COATED. FRONT PANELS OF DOORS AND DRAWERS MADE OF SOLID WOOD WITH OPTIONAL LEATHER OR FABRIC COVERS.

Frames: coated in fine structure black



Solid. wood variants:		
	Old oak	Old oak black stained
	PG4	PG2
		
Lacquered	✓	✓

18.03.2022

Measurements: cm
Scale: 1:50

High Board
HB1

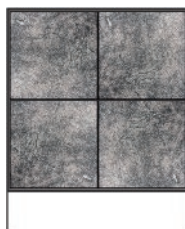

Front view (High Board)

Sideboard
SB1



Front view (Sideboard)



Side view (High Board)

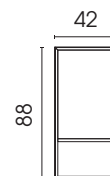

Side view (Sideboard)

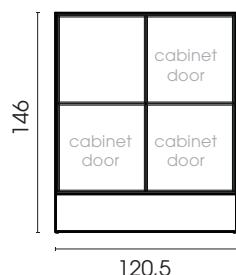

**High Board
HB1**

120,5 / 146 / 42
(4 cabinet doors - covered)
(4 shelves / back panel)

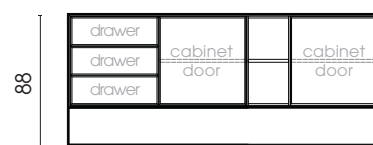

**Sideboard
SB1**

207,5 / 88 / 42
(3 drawers / 2 cabinet doors - covered)
(3 shelves / back panel)

Each piece of furniture is handmade and unique. Deviations to the listed measurements may be caused by:

1. different upholstery materials (fabric, leather), 2. processing of ticking mats, 3. the pressure to combine individual parts, etc.
- The seat comfort of a sofa type with larger seat depth usually differs from one with lower depth.

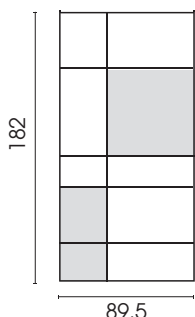
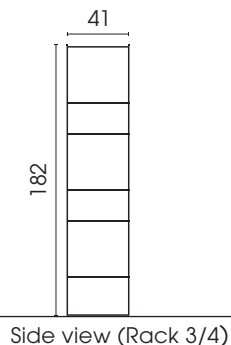
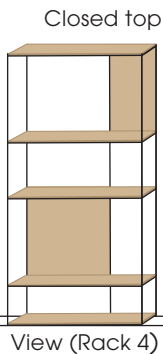
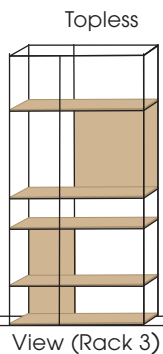

Rack R3

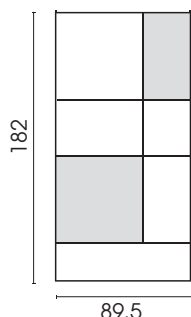

Rack R4

Rack R3
topless
89,5 / 182 / 41

Rack R4
closed top
89,5 / 182 / 41

Combinations with rack R3/R4

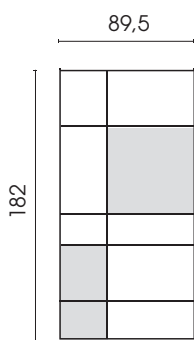

- Type R3

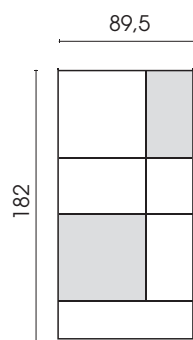

- Type R4

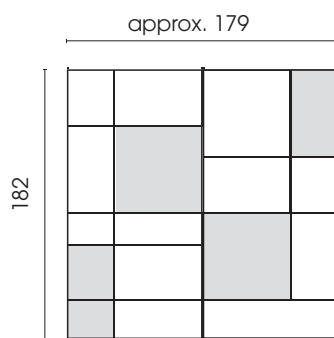

- Type R3
- Type R4

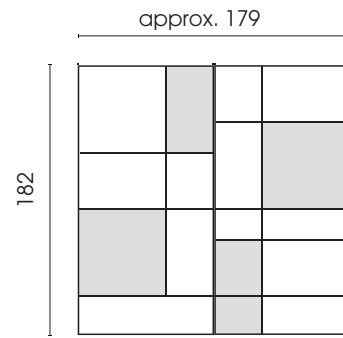

- Type R4
- Type R3

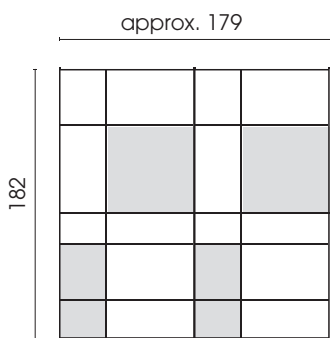

- 2 x Type R3

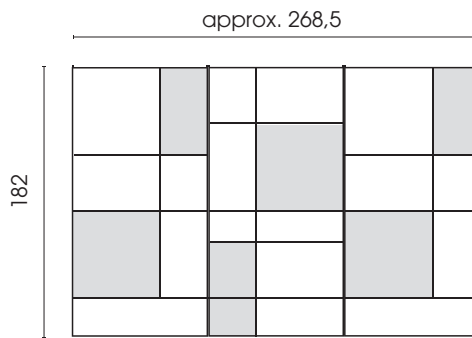

- 2 x Typ R4
- Type R3

Each piece of furniture is handmade and unique. Deviations to the listed measurements may be caused by:
1. different upholstery materials (fabric, leather), 2. processing of ticking mats, 3. the pressure to combine individual parts, etc.
The seat comfort of a sofa type with larger seat depth usually differs from one with lower depth.